



GRILL SMARTER EAT BETTER



SMART CONTROL USER GUIDE

- GET TO KNOW YOUR APP 29
- CONNECTING TO YOUR GRILL 31
 - POINT-TO-POINT 31
 - WIFI MODE 32
 - SERVER MODE 34
- CONTROLLING YOUR GRILL 36
- USING MEAT PROBES 37
- TIMER & STOPWATCH 37
- PROFILES 38
- RECIPES 41
- FIRMWARE 42
- MULTI-GRILL MODE 44



GET TO KNOW YOUR APP

HOME

The Home screen allows you connect to your grill, turn it on/off, view and set grill and food probe temperatures, select Profiles, and set the Timer or Stopwatch.

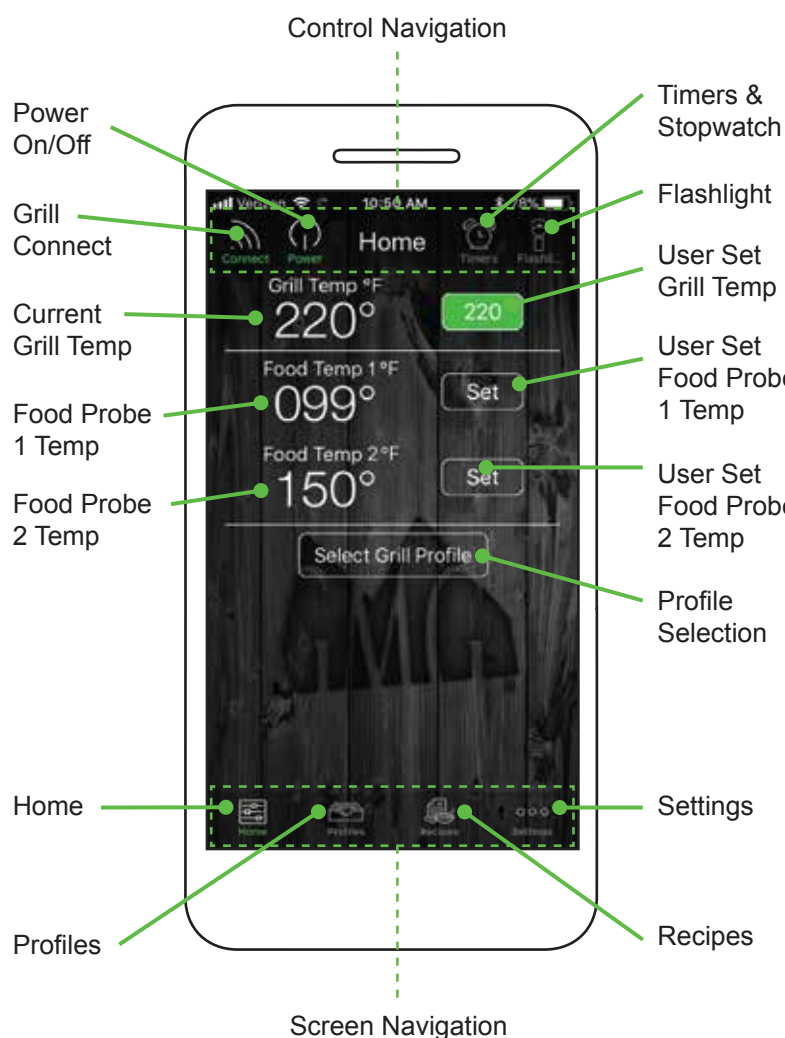

PROFILES

Profiles allow you to create and use customizable and programmable cooking instructions to make grilling that much easier! Whether you are smoking ribs, slow-cooking a brisket or just grilling chicken breasts, Profiles allow you to easily record and repeat your cook at the click of a button.

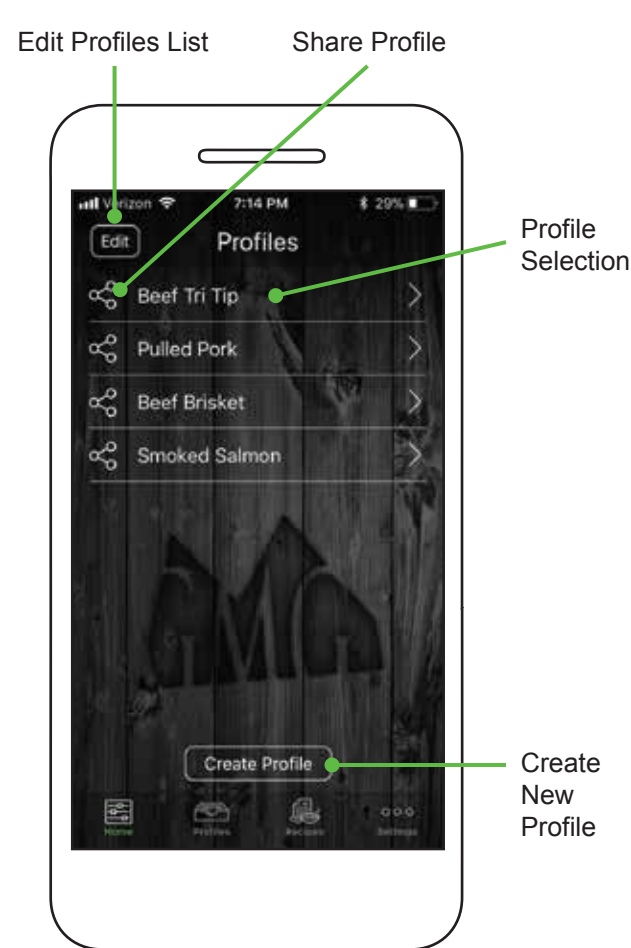

RECIPES

You have access to all of our great GMG recipes at your fingertips! Scroll through our 12 different recipe categories to find what you're in the mood for. Use the icon menu at the top to switch between categories.



SETTINGS

The settings screen provides further grill and app information including grill and WiFi mode control, temp and alert settings, grill updating and calibration, and access to app and grill support and tutorials.

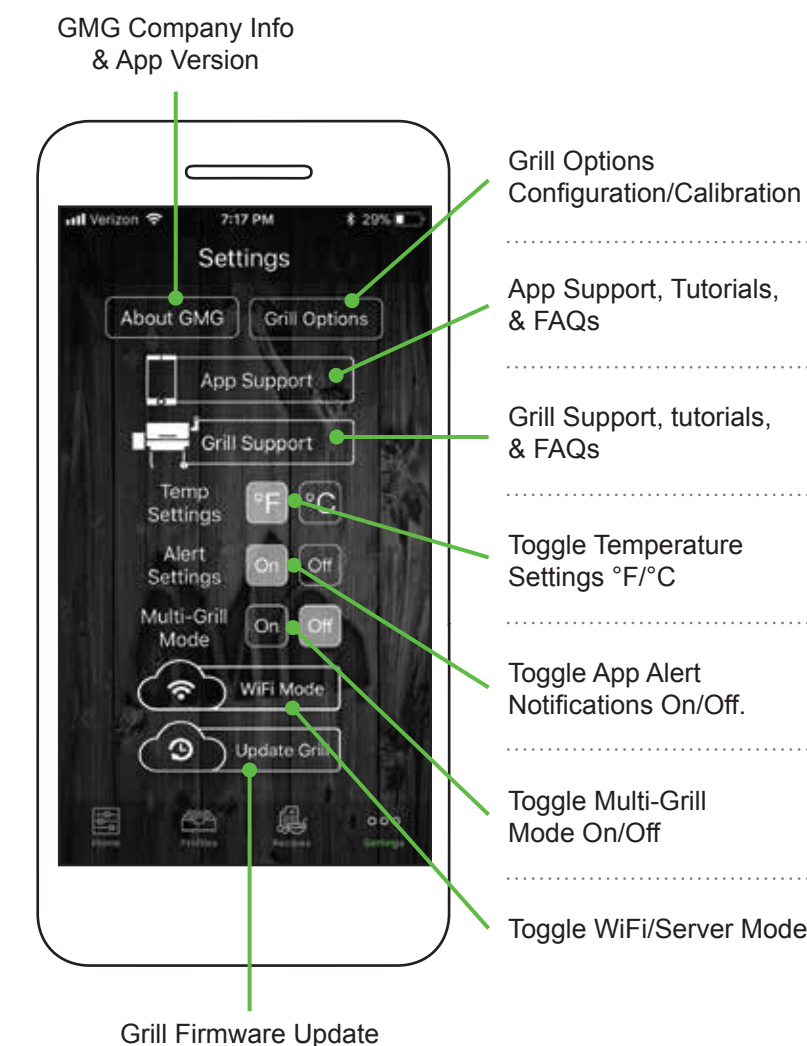

GMG SMART CONTROL APP

Download the app by scanning the QR code, or search Green Mountain Grills in the iTunes App Store or on Google Play.



iOS



Android



CONNECTING TO YOUR GRILL

Point-to-Point

CONFIRM POWER & PASSWORD

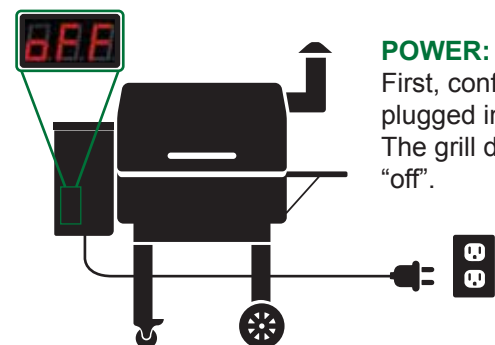

POWER:
First, confirm the grill is plugged in and has power. The grill display should read "off".

DANIEL BOONE
Operating Voltage: 12V DC
Average Power: 10W
Temp Range: 150°- 550°F
Net Weight: 184 LBS
Sense-Mate Program Control
DATE: 8/2019 S/N: 12065717
DBWF

GRILL PASSWORD:
Your WiFi password is your grill's serial number.

The number is located on the green plate on the back of the grill. When entering the password, use only the numbers, NOT the letters below.



IOS



Go to "Settings > WiFi".



Click on WiFi.

Make sure your WiFi is on.



When WiFi is enabled, a list of networks will be displayed.

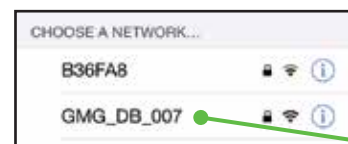

Select the network that begins with "GMG_".

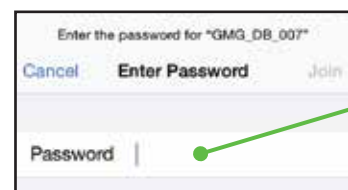

Enter the password for your grill. Press Join.

It may take up to 1 minute to connect.



Once connected, you will see a check mark.



ANDROID

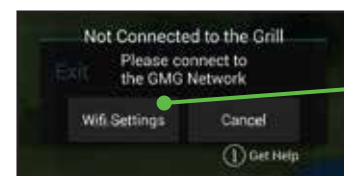

Start the app. Wait for the WiFi pop-up, then press "WiFi Settings."

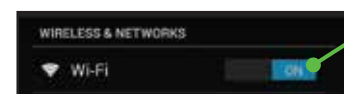

Make sure your WiFi is on.

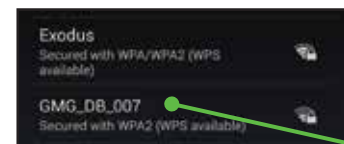

When WiFi is enabled, a list of networks will be displayed.



Select the network that begins with "GMG_".

Enter the password for your grill. Press Connect.

It may take up to 1 minute to connect.



Once you are connected, a "Connected" message will appear below the network.

CONNECTING THE APP TO YOUR GRILL



Once you've connected your smartphone to the grill's WiFi network, you can connect your grill to the app.

Press the Connect button. The app will detect if there is a grill nearby.



DISCONNECTING:

To disconnect the app from the grill, simply press the Connect button again.



CONNECTING TO YOUR GRILL

WiFi Mode

CONNECTING VIA WIFI MODE

In order to connect via WiFi mode you must first establish a point-to-point connection to your grill's network.



Single-Grill Mode:

Once you've connected point-to-point, make sure the Connect button on the Home screen is active and the app is reading the grill temperature.

Navigate to the Settings screen and select the WiFi Mode button.

The next steps will connect your grill to your home network.



Android: Choose your network from the drop down menu.

iOS: Type in your network name (case sensitive).

Please be within 20 feet of your home router for the initial update.

Now that the network is selected, enter your password. Check the Show Password box to display the characters (passwords are case sensitive).

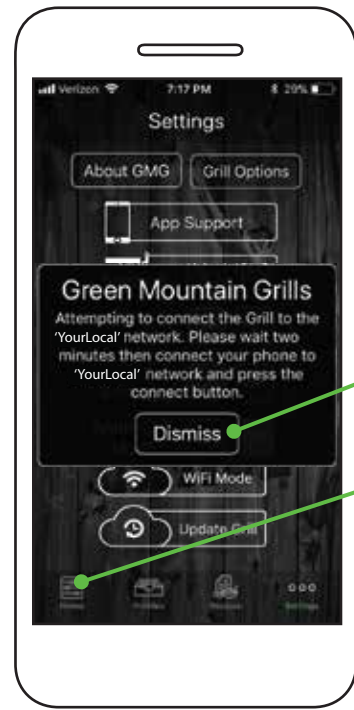

Once you've entered your home WiFi network and password, allow a couple minutes for the grill to connect to your network.

Click Dismiss.

Return to the Home screen.

Next, the app will search for grills on your local network. This step will start the Broadcast Mode.



Connect to your grill.

This process has several steps and will show various windows.

First, it will check for known grills. Since you haven't connected before, it will not find any. In the future, the process of connecting will speed up.

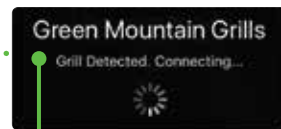
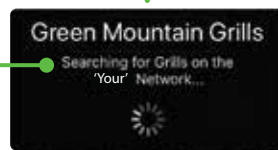

We are almost there. The grill has been detected and the app is now attempting to connect.



Now that the grill is in Broadcast Mode, the next step is to switch it to the Client Mode. This step requires the grill to briefly disconnect and reconnect to the router with a new configuration, which takes around a minute.

Note: This step only occurs either the first time you connect, after turning the grill on or after switching it over to a home network for the first time. Future connections will be much faster as long as the grill is left on.

The dialogue should now display "Connected, Happy Grilling!" Temperature readings should be coming shortly thereafter.

Congrats! Your grill is now connected over local WiFi.



CONNECTING TO YOUR GRILL

Server Mode

UNDERSTANDING SERVER MODE

Server mode is designed for remote monitoring and grill control when you are outside of your home WiFi network. You can control and monitor the grill while out running errands or just hanging out at home.

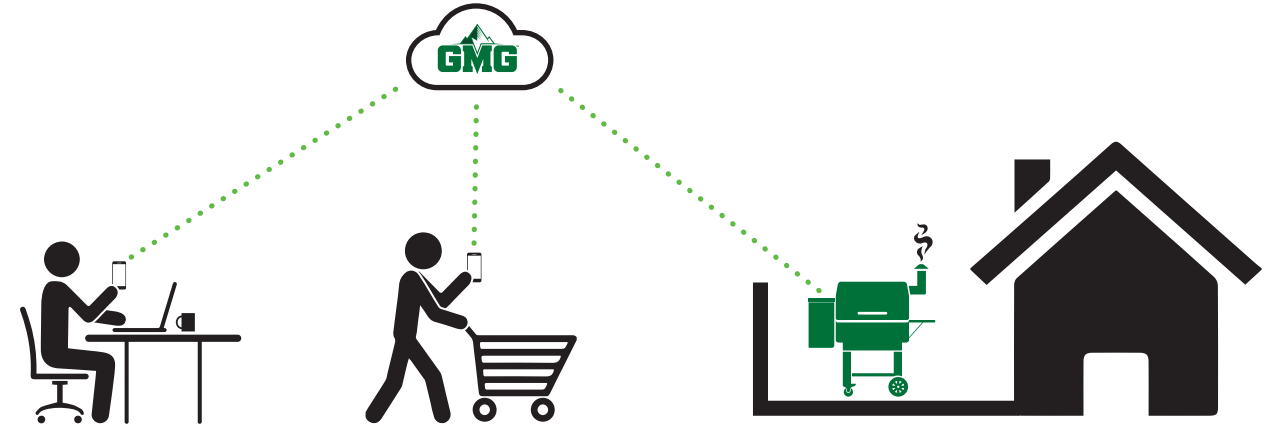

Capabilities:

- Turn on the grill (only from home WiFi network)
- Turn off the grill
- Increase/decrease the grill temp
- Set the food probe temp
- Start/stop a food profile

Notifications:

You will be notified when:

- The target temperature hits on the grill or food probe
- When a profile step or profile is complete
- The low pellet alarm is activated

CONNECTING VIA SERVER MODE

Your grill must be connected to your local home WiFi network before you can connect to the GMG server. See the previous section on how to connect via WiFi Mode.



Once you've connected via WiFi Mode, go to the Settings screen. This should now read Server Mode.

Tap the Server Mode button.



A prompt will display. Enter your home WiFi network and password.

Press Confirm.

CONNECTING VIA SERVER MODE (CONTINUED)



The grill will take approximately 30–45 seconds to contact and connect to the GMG Server.

When the grill connects, a prompt will appear, saying "Grill Connected to Server."

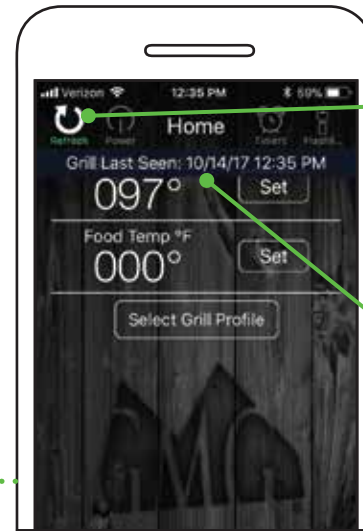

Go to the app's Home screen. A new Refresh button will appear in the upper left-hand corner in place of the Connect button.

Tap the Refresh button to display the last date and time the grill connected to the server.

The grill is now in Server Mode! Monitor and control the grill from any cell phone network.



To disconnect from Server Mode:

Go to the Settings screen.

Click the Leave Server button.

The grill should be set back to WiFi Mode. To reconnect to the grill, return to the Home screen and press Connect.

In some situations, the grill will go back to point-to-point mode. If this happens, repeat the WiFi connection process.

Happy Grilling!

Pro Tips:

1. You must have firmware version 1.2 or higher to use server mode. See the firmware section on page 38 for instructions on checking and updating your firmware.
2. Make sure your Android or iOS app is up to date.
3. For safety reasons, you can only turn on the grill using Server Mode if you are within range of your WiFi network.

CONTROLLING YOUR GRILL

TURNING YOUR GRILL ON/OFF



ON: Make sure you're connected to the grill.

Tap the Power button. A pop-up window will display.

Press Confirm to turn the grill on. It will begin its 0-1-2-3 startup sequence.



OFF: Tap the Power button, then press Confirm. The grill will cycle into Fan Mode.

FAN MODE: This will cool down the firebox. When it has reached a cool temp, the grill's digital control board will read "off".

SETTING GRILL TEMP



Allow your grill to reach 150°F (66°C) before setting your desired grill temp.

Press the Set button next to the grill temp.

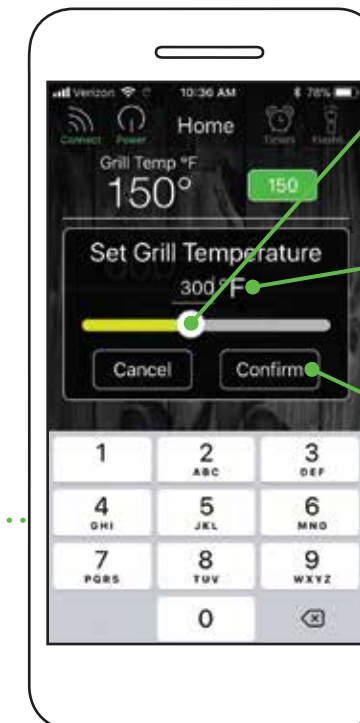

Move the slider to the temp you want.

Pro Tip:

Tap the temp digits for a more precise control.

Press Confirm. The grill will now adjust to the new set temp.

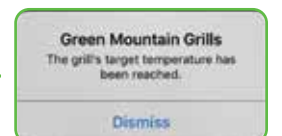



USING MEAT PROBES

SETTING PROBE ALERTS

Track the internal temp of your food with our dual meat probes. Monitor multiple meats at the same time or if you're cooking a large cut of meat, keep track of outer and inner temps simultaneously.

Set the food probe alert by pressing the Set button next to the food temp.

Move the slider to the desired temp for your food probe alert.

Press Confirm to set the alert.

The food probe alert will now trigger an audible alarm on the grill when the set temp of the food has been reached. If your device is connected, it will receive an alert notification.



PROFILES

Profiles allow you to create and use customizable and programmable cooking instructions to make grilling that much easier! Whether you are smoking ribs, slow-cooking a brisket or just grilling chicken breasts, Profiles allow you to easily record and repeat your cook at the click of a button.

CREATING PROFILES

To create a new Profile, go to the Profiles screen by tapping the icon at the bottom of the Home screen.

Press the Create Profile button.

Choose Profile Name and enter a name for your Profile.

Press the Save button.

CREATING STEPS

Steps allow you to automate temperature changes in a Profile. You can select between temperature and time-dependent Steps. Temperature-dependent Steps are dictated by the food probe. Time-dependent Steps use time to dictate the process.

To add a new Step press the Add Step button.

TEMP TRIGGERED: Using your GMG food probe, you can trigger a Profile Step based on the internal temp of a food item.

When the food probe reaches the set temp, the next Step in the Profile will activate (i.e. increase or decrease the grill temp when internal temp is reached).

Press Confirm to save the new Profile Step.

TIME TRIGGERED: Each Step will maintain a temperature for a specified amount of time. When the selected time has run out, the next Step in the Profile will activate.

Press Confirm to save the new Profile Step.



USING TIMERS & STOPWATCH

Activate the Timers icon in the top control navigation. This will drop down the Stopwatch and Timer controls.

Start Stopwatch.

Reset Stopwatch.

Start Timer.

Set a Timer.

Pro Tip: Experimenting with cooking times using the Stopwatch can help you build food Profiles.

The Timer box will pop up. Select the hours and minutes. Tap Confirm to set the Timer.

An alarm will sound when the Timer runs out.



ENDING STEPS

For the end Step, the grill will automatically display a Keep Warm setting or you can change it to Turn Off, which will switch the grill into Fan Mode. To switch between the two settings simply tap the current button.

If you're a new user, we recommend that you use the Keep Warm setting.

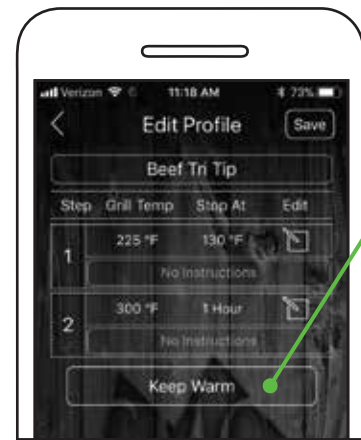

Keep Warm: This setting will set the grill temp to 150°F and stay there until the grill is turned off.

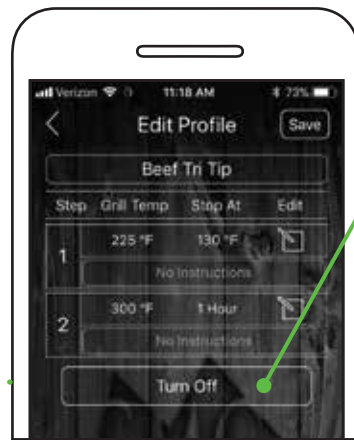

Turn Off: This mode will immediately initiate Fan Mode.

Pro Tip:

If your grill goes into Fan Mode and food is not ready, do a hot restart.

STARTING PROFILES

! Before you begin using a previously created Profile, make sure the grill is warmed up.



Press the Select Grill Profile button.

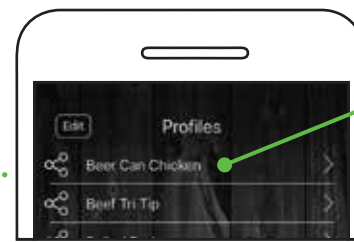

Choose the Profile you would like to run.

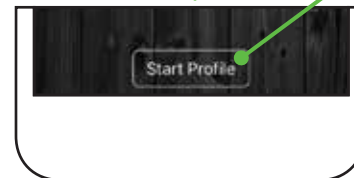

Press the Start Profile button.



Press Confirm.

Profiles are loaded into the grill's memory, and will continue to run even if your phone is disconnected.



EDITING PROFILES

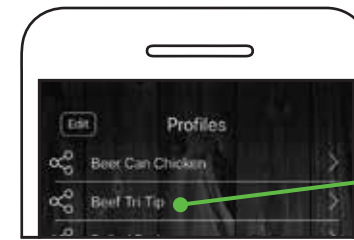

To edit a Profile:

Tap the Profile.

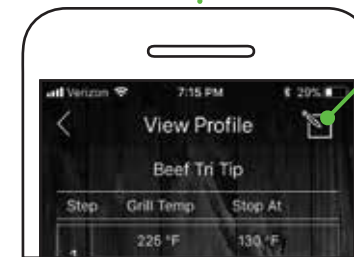

Tap the Edit button. The edit mode will open.

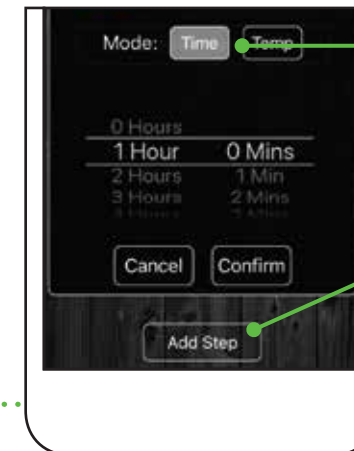

To set the grill temp, stop time or set the food probe temp, tap the relevant button.

To add a step, tap Add Step. To remove one, tap Delete.

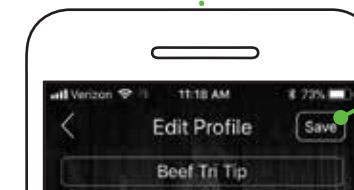

Tap the Save button to save your edits.

DELETING PROFILES

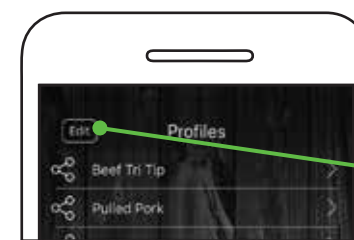

To delete a Profile:

Tap the edit button.



Tap the red delete button.

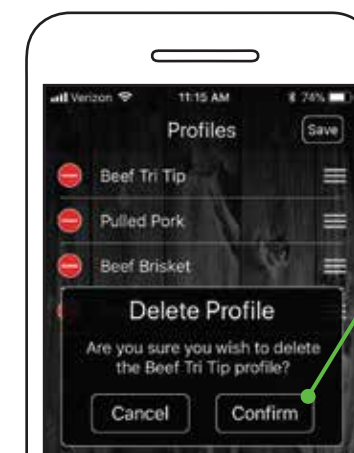

Press Confirm.

To move Profiles around, press and hold the 3 bars next to the Profile and drag up or down your list.



RECIPES

You have access to all of our great GMG recipes at your fingertips! Scroll through our 12 different recipe categories to find what you're in the mood for. Use the icon menu at the top to switch between categories.

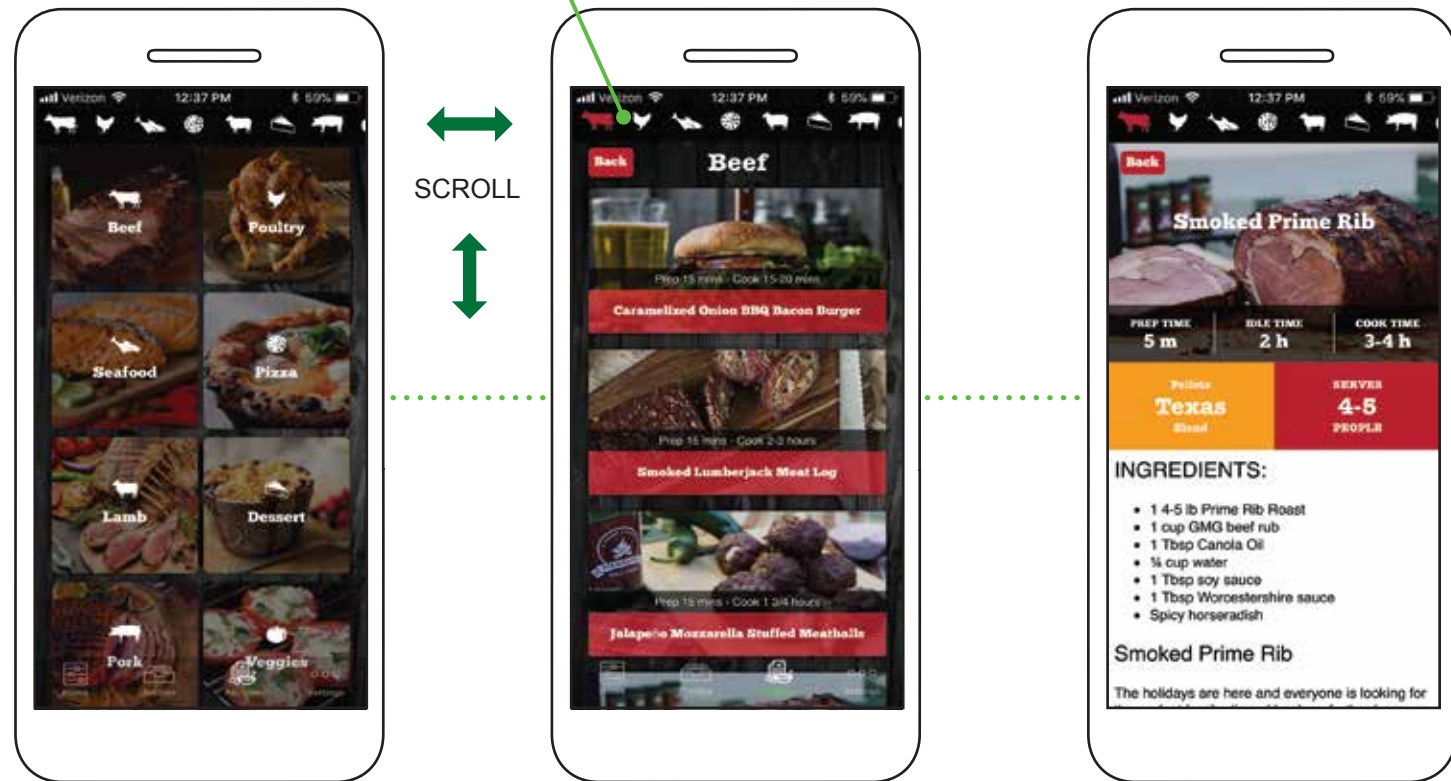

GRILL FIRMWARE

CHECKING FIRMWARE VERSION

To check what version of GMG firmware your grill is running, follow these steps:



Toggle the grill off with the power switch.

Hold down the up button. While holding it down, switch the grill on and continue to hold up the button for about 10 secs.

The LCD screen will flash the version number followed by the grill's serial number. If no version number is displayed, you will need to update the firmware.

Latest Firmware Versions:
Daniel Boone - 1.8

** Subject to change with updates*

UPDATING FIRMWARE

To update your grill's firmware you will need to connect your grill to your home WiFi network and download the update. Firmware updates and application updates are separate. You will need to be at least within 20 feet of your home network. Updating your firmware typically isn't necessary unless you are experiencing an issue with the device.



First, make sure the grill is on, and the LCD is displaying "off". Make sure you are not cooking while you attempt the update.

Next, go to the settings screen and select the Update Grill button to begin the update process.



Select the network you would like to use to update your grill. The network must have a live network connection.

Android: Select the network from the drop down menu.

iOS: Type in your network (case sensitive).

Enter the password for your network and press Confirm. The password is case sensitive.

UPDATING FIRMWARE (CONTINUED)

Your grill's LCD panel will display "UPD" and connect to your local network. Once connected, the grill will start downloading the new firmware.



The LCD screen will start at "0" and climb to "100." If the update is successful, the LCD panel will display "SUC."



Once you see "SUC" unplug the grill and plug it back in again. The system will now install the update and verify if it is installed correctly. You will see the grill count from "000" to "100" during this time. When the update is complete, the grill will display "off". It will then disconnect from your local network and broadcast via the GMG network again.



If the update is unsuccessful, the LCD panel will display "FAL."



If your update fails:

1. You are not close enough to your home network (needs to be within 20 feet).
2. You don't have the latest version of firmware and the package update can't download.
3. Your network does not have a password or is not compatible with the grill.

APP WARNINGS



FREE CIRCUIT WARNING

There is an open circuit in your grill. Unplug from power source immediately.

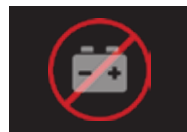

BATTERY WARNING

Low voltage detected on the grill. Check power source.



LOW FUEL WARNING

The low pellet alarm has been triggered. Please check the hopper.



FAN WARNING

One of the fans is not working properly. Discontinue use immediately.

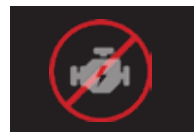

MOTOR WARNING

The auger motor is not working properly. Unplug from power source immediately.



MULTI-GRILL MODE

If you have more than one grill with WiFi, you can control each grill separately. You will need to connect to each grill separately and connect them to your local WiFi following the steps in single-grill mode.

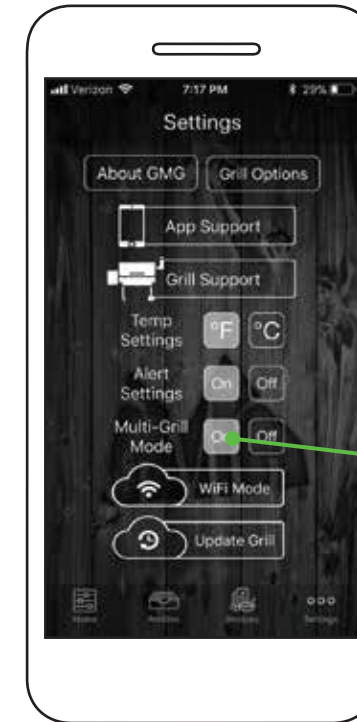

Next, follow these steps:

Single-grill mode connects immediately to the first grill it finds. By default the app starts in single-grill mode because it is the most common configuration.

Multi-grill mode extends these steps a little longer than normal to allow it to find every available grill on the network.



After you press Connect in Multi-Grill Mode, the GMG app will search for all available grills on the local network and display them in the Select Grill pop-up window.

Choose between the grills displayed in the toggle bar.

Grills are identified by their serial number.

After selecting a grill, press Confirm to connect.



WARRANTY & SUPPORT



REGISTER YOUR WARRANTY HERE:
greenmountaingrills.com/warranty-registration

This LIMITED WARRANTY covers defects in workmanship and materials for a period of three (3) years from the date of first retail purchase. During the warranty period, GMG Products, LLC (dba Green Mountain Grills) will replace or repair, at its sole option, any defective Green Mountain grill returned to us, or to one of our dealers, by its original purchaser. Any claims under this warranty must be received by the expiration of the warranty period.

This warranty does not cover problems that result from abuse, accident, misuse, or problems with electrical power. It does not cover cosmetic elements and components, such as paint and other finishes. It does not cover uses not in accordance with the instruction manual. It does not cover commercial use of the product. It specifically excludes products for which Green Mountain Grills has not received payment.

THIS WARRANTY GIVES YOU SPECIFIC LEGAL RIGHTS WHICH MAY VARY FROM STATE TO STATE (PROVINCE TO PROVINCE IN CANADA). GREEN MOUNTAIN GRILLS RESPONSIBILITY FOR DEFECTS IN MATERIAL AND WORKMANSHIP SHALL BE LIMITED TO REPAIR AND/OR REPLACEMENT AS SET FORTH IN THIS WARRANTY. ALL EXPRESS AND IMPLIED WARRANTIES, INCLUDING, BUT NOT LIMITED TO, ANY IMPLIED WARRANTIES AND WARRANTIES OF MERCHANTABILITY OR FITNESS FOR A PARTICULAR PURPOSE ARE DISCLAIMED. NO OTHER WARRANTIES ARE PROVIDED.

IN NO EVENT WILL GMG PRODUCTS, LLC (dba GREEN MOUNTAIN GRILLS) HAVE ANY LIABILITY FOR SPECIAL, INCIDENTAL OR CONSEQUENTIAL DAMAGES, WHETHER TO THE ORIGINAL PURCHASER OR WITH RESPECT TO ANY THIRD-PARTY CLAIMS FOR DAMAGES AGAINST THE RETAIL PURCHASER OF THIS PRODUCT. SOME STATES (PROVINCES IN CANADA) DO NOT ALLOW THE EXCLUSION OR LIMITATION OF INCIDENTAL OR CONSEQUENTIAL DAMAGES, SO THIS MAY NOT APPLY TO YOU.

To exercise your rights under this warranty, contact the dealer from whom you purchased it, or call us at 530-347-9167.



WE'RE COMMITTED TO MAINTAINING THE BEST CUSTOMER SERVICE IN THE INDUSTRY.

For assembly and general operation instructions, check out:
greenmountaingrills.com/new-grill-owners

For troubleshooting and service tips, check out:
greenmountaingrills.com/support

GRILL SUPPORT

Call 1.800.603.3398 - Option 1
Hours 8 am - 6 pm PST M - F, 9 am - 6 pm PST Sat - Sun
(Closed on major holidays)

Contact Us:
Green Mountain Grills LLC.
316 California Ave. Suite 1065
Reno, NV 89509

Toll Free 1.800.603.3398
Phone 530.347.9167
Fax 530.347.9710

APP SUPPORT

Call 1.800.603.3398 - Option 15
Email AppSupport@greenmountaingrills.com
Hours 10 am - 6 pm PST M - F, 9 am - 5 pm PST Sat
(Closed on Sundays and major holidays)

FOLLOW THE GMG NATION

STAY IN TUNE WITH WHAT YOUR FELLOW BACKYARD PITMASTERS ARE PREPPING FOR THEIR WEEKEND SMOKE WITH
[#GMGNATION](https://twitter.com/GMGNATION) [#GREENMOUNTAINGRILLS](https://twitter.com/GREENMOUNTAINGRILLS) [#GMGPRIME](https://twitter.com/GMGPRIME)

LOOK OUT FOR NEW RECIPES, EVENTS, GIVEAWAYS AND ANNOUNCEMENTS FROM YOUR FAVORITE PRODUCER OF WOOD-FIRED FLAVOR.
[WWW.GREENMOUNTAINGRILLS.COM](https://www.greenmountaingrills.com)



[@GREENMOUNTAINGRILLS](https://www.instagram.com/greenmountaingrills)