

Installation & Operator's Manual

LS12 Liquid Spray System 120 Gallon Tank

1. Locate the position on the truck frame you will be mounting the reservoir frame and secure in place.
2. Install the reservoir in the frame so the ports on the preferred side of the truck. (You may need to remove the fittings, install the tank, and reinstall.)
3. Locate the position where you will be mounting the Enclosure mounting plate. Note: The included mounting plate is predrilled to match the Enclosure and to fit on the side of the reservoir's frame.
4. Use the included hardware to mount the Enclosure. All (4) mounting holes on Enclosure's flanges must be used.
5. Plumb: Reservoir, ball valve, check valve, filter, pump enclosure and spray nozzles according to plumbing schematic, Fig 3. Use only Loctite™ #30534 or Permatex™ #2 thread sealants. **DO NOT USE TEFLON TAPE**

Cab Controller Installation Instructions (fig.1)

1. Install cab controller (#WSE1) in cab for convenient driver operation. Mounting bracket and fasteners included.
2. Route 8' wire harness (#WSE24) under dash from controller (#WSE1) to truck's fuse panel.
3. Ground "black" wire from controller to truck frame or truck's battery (not dash).
4. Attach "green" wire in 8' wire harness (#WSE24) to a fused and keyed 15 Amp hot wire circuit.
5. Connect main power "white" wire in 8' wire harness (#WSE24) to fuse box that is "hot" full time or to battery "positive".
6. Route the 25' wire harness (#WSE25) from the rear of the spreader to the cab. Plug connector on controller (#WSE1) to the connector on pump harness (#WSE25).

Fig. 1 - WSE1 Cab Controller



Liquid Spray System Operating Instructions

1. Read all instructions before operating. Always wear hand, eye, and skin protection when working with de-icing chemicals. Make sure everyone is standing clear of liquid spray system before operating.
2. Inspect all plumbing for leaks.
3. Open ball valve (#WSE10) at the reservoir.
4. Make sure reservoir has adequate supply of clean de-icing liquid. Do not operate pump without liquid.
5. Before turning the cab controller on, turn the black speed control knob counter clockwise until it stops to set the pump at the slowest speed.
6. To energize system, turn red power button to illuminate LCD screen "on" position.
7. Increase pump speed to desired liquid spray application rate by turning black knob clockwise.
8. If the red low pressure warning light/alarm comes on, the reservoir is empty or the pump is off. Do not operate pump without liquid. **Note: Low pressure light and alarm will sound each time system is started. This is normal and occurs until sufficient pressure is achieved to open pressure switch (turning off light/buzzer).**
9. Close ball valve (#WSE10) at the reservoir when not in use.

CAUTION

Always wear hand, eye, and skin protection when working with de-icing chemicals. Use extreme care!

Fig.2 - Prewet Plumbing Diagram

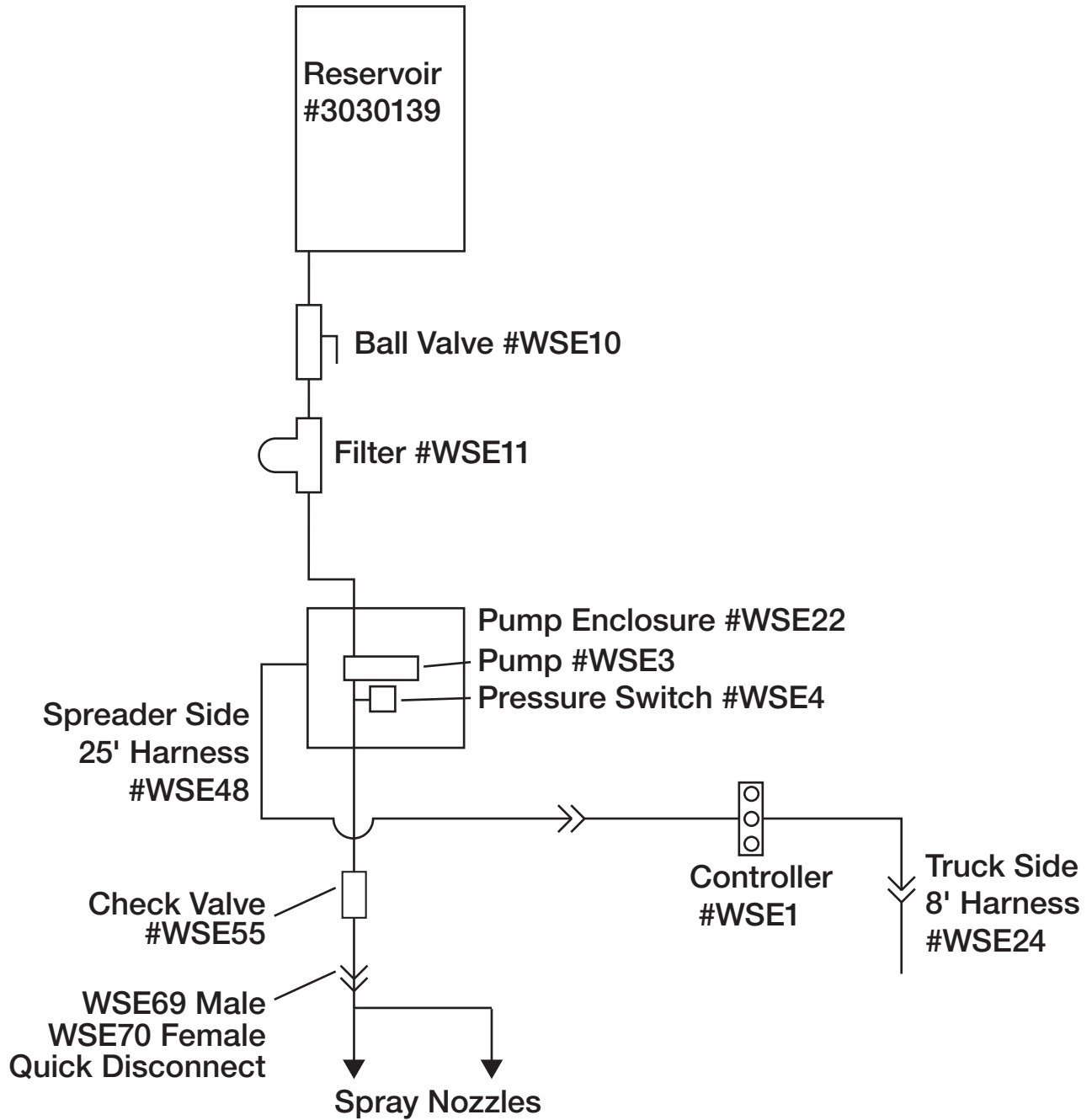

Fig. 3 - Filter/Valve Assembly

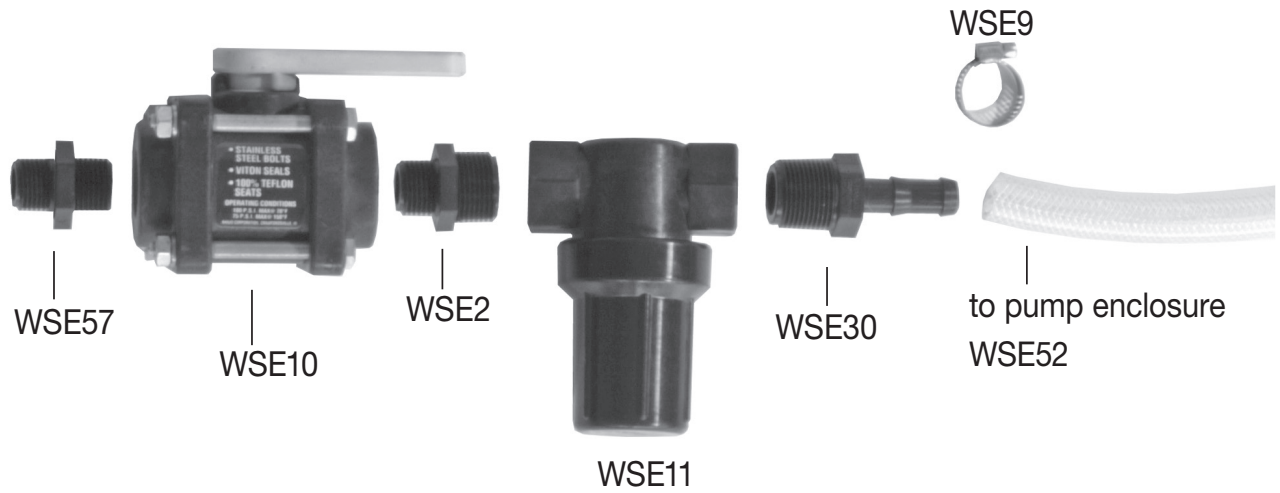
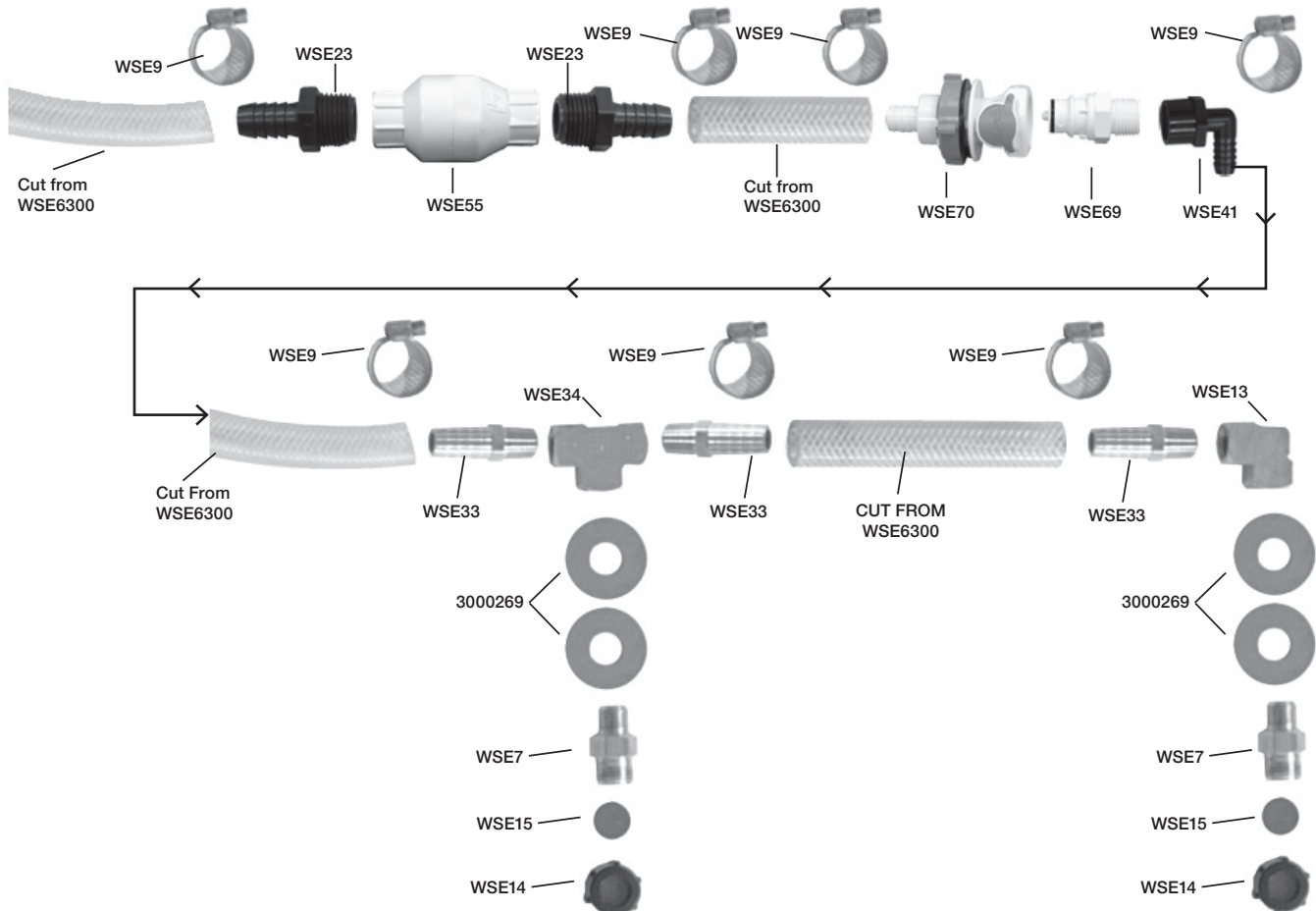
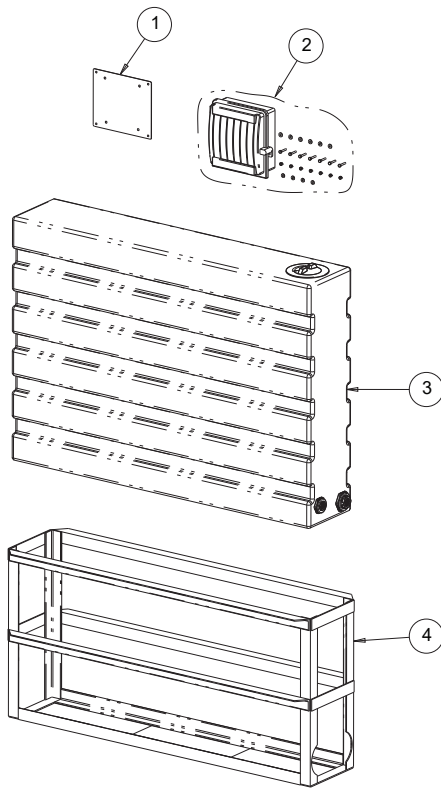

Fig. 4 - Nozzle Assembly



Bill of Materials



ITEM	PART NO.	QTY.	DESCRIPTION
1	3034588	1	PLATE, MOUNT, ENCLOSURE ELECTRIC
2	LS102	1	ENCLOSURE ASSY, HYD
SEE FIGURE 5 FOR INTERNAL COMPONENTS OF LS102			
3	3030139	1	RESERVOIR, 120 GALLON
4	3033887	1	FRAME, MOUNTING, 120 GALLON RESERVOIR
FOLLOWING PARTS ARE SHOWN ON FIGURES 3 AND 4			
	2958393	1	PLUG, POLY, 1 IN MNPT
	3000269	4	WASHER, FLAT, 1/2 USS SST
	WSE2	1	NIPPLE, POLY, HEX 3/4 X 1/2
	WSE7	2	NOZZLE BODY, BRASS
	WSE9	6	HOSE CLAMP
	WSE10	1	BALL VALVE, POLY, 1/2 FNPT
	WSE11	1	FILTER, POLY, 3/4 FNPT
	WSE13	1	ELBOW, BRASS, 1/4 FNPT X 1/4 FNPT
	WSE14	2	NOZZLE, CAP
	WSE15	2	NOZZLE, RUBBER
	WSE23	2	BARB, POLY, 1/2 MNPT X 1/2 HB
	WSE30	1	BARB, POLY, 3/4 MNPT X 1/2 HB
	WSE33	3	BARB, HOSE, BRASS, 1/4 MNPT X 1/2 HB
	WSE34	1	TEE, BRASS, 1/4 FNPT X 1/4 FNPT X 1/4 FNPT
	WSE41	1	ELBOW, POLY, 1/2 FNPT X 1/2 HB
	WSE55	1	CHECK VALVE
	WSE57	1	NIPPLE, POLY, HEX 1/2 MNPT X 1/2 MNPT
	WSE69	1	QUICK COUPLER, POLY, 1/2 MNPT X 3/4 MALE
	WSE70	1	QUICK COUPLER, POLY, 1/2 BARB X 3/4 FEMALE
	WSE6300	1	HOSE, POLY, 1/2 X 300 IN
FOLLOWING PARTS ARE SHOWN IN FIGURES 1 AND 2			
	WSE1	1	CONTROLLER, IN CAB
	WSE24	1	HARNESS, 8FT TRUCK SIDE
	WSE48	1	HARNESS, 25FT SPREADER SIDE

Fig. 5 Internal Components of LS102

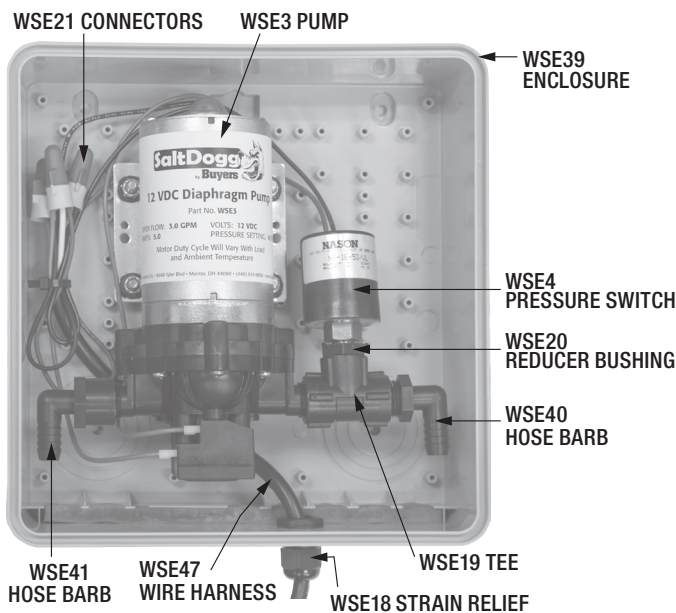

CAUTION

Always wear hand, eye, and skin protection when working with de-icing chemicals. Make sure everyone is standing clear of liquid spray system before operating.

SAFETY ALERT SYMBOL

 This Symbol Means **ATTENTION!**
Please Read & Understand Completely Before Operating!

EQUIPMENT INSTALLERS & OPERATORS:

TURN OFF ALL POWER BEFORE PERFORMING ANY SERVICE OPERATIONS.

- Follow Recommended Operating Procedure.
- Keep Equipment In Safe Operating Condition At All Times.
- Recognize & Avoid Hazards While Operating, Servicing and Maintaining Equipment.

 **CAUTION**
RESERVOIR & COMPONENTS MAY CONTAIN HAZARDOUS MATERIAL. HANDLE WITH CARE.

WARRANTY

Buyers Products Co. warrants all truck/trailer hardware manufactured or distributed by it, to be free from defects in material and workmanship for a period of one year from date of shipment. Parts must be properly installed and used under normal conditions. Any product which has been altered, including modification, misuse, accident or lack of maintenance will not be considered under warranty. Normal wear is excluded. The sole responsibility of Buyers Products Co. under this warranty is limited to repairing or replacing any part or parts which are returned, prepaid, and are found to be defective by Buyers Products Co. Authorization from Buyers Products Co. must be obtained before returning any part. No charges for transportation or labor performed on Buyers' products will be allowed under this warranty.