

Installation & Operator's Manual

LS9H Liquid Spray System

30 Gallon Tank

1. Locate the position where you will be mounting the Enclosure assembly. **Note: The included mounting plate is predrilled to match the Enclosure mounting holes and may make installation easier if it is used.**
2. Use the included hardware to mount the Enclosure. All (4) mounting holes on Enclosure's flanges must be used along with (2) internal mounting holes.

WARNING

Two inside bolts must be installed through the internal enclosure plate and mounting bracket in order to secure the assembly.

3. Locate the position where you will be mounting the tank to the vehicle frame.

4. Use the Tank to determine the correct spacing of the Support Brackets and mark their mounting locations on the vehicle frame.
5. Mount the included Reservoir Support Brackets to the frame. **Note: Standard hardware is provided. If different sizes are required these will need to be purchased from a local hardware store.**
6. Mount the Tank to the Support Brackets. **Note: Eyebolts and straps are provided as one method of attachment. Holes will need to be drilled in the support brackets to mount the eyebolts.**
7. Plumb: Reservoir, ball valve, check valve, filter, pump enclosure and spray nozzles according to plumbing schematic, Fig. 3. Use only Loctite™ #30534 or Permatex™ #2 thread sealants. **DO NOT USE TEFLON TAPE**
8. Refer to Fig. 2 for flow adjustment

Fig. 1

WSE75
Cab Controller
box (Front)



WSE75
(Back)

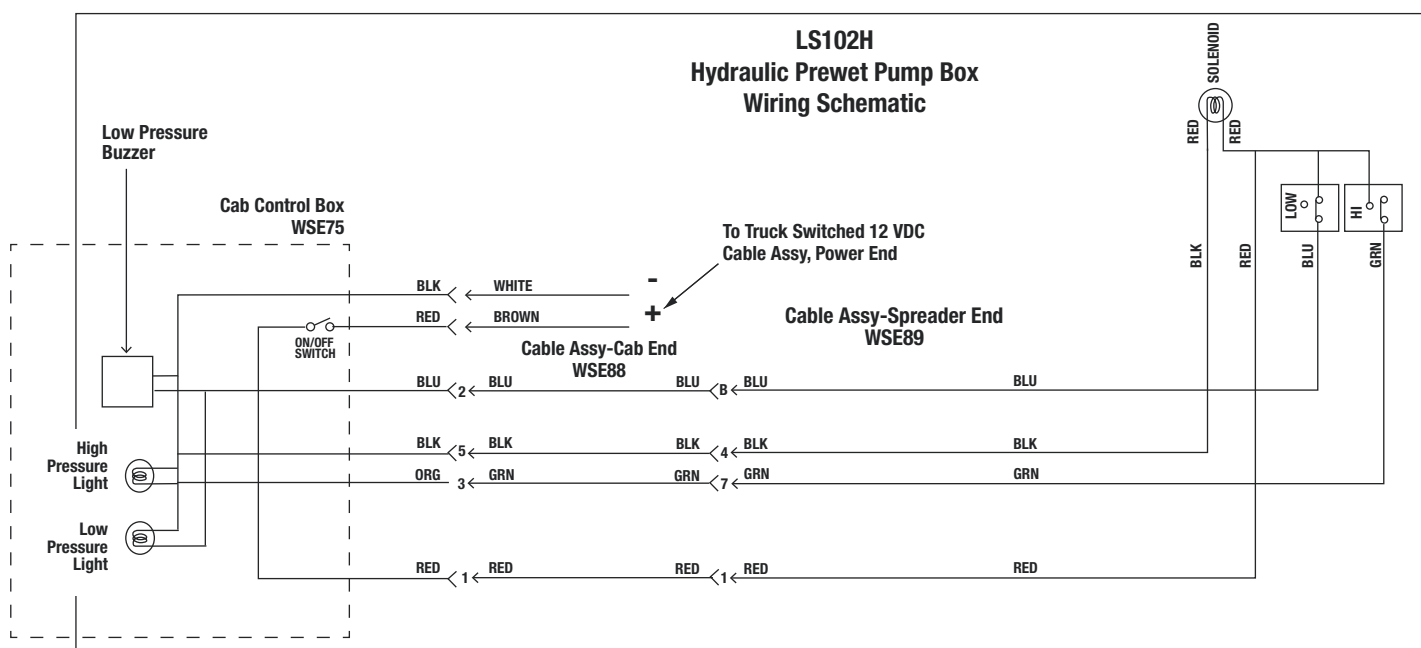
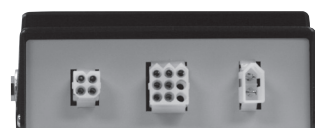

Fig. 2 - Hydraulic Schematic

NOTE: It takes five revolutions of the black dial on the WSE87 to fully open it. This should be the factory preset. There is also a jam nut that should be tightened to prevent loosening in shipment. The pre-wet pump delivers 4.5GPM when the valve is fully opened.

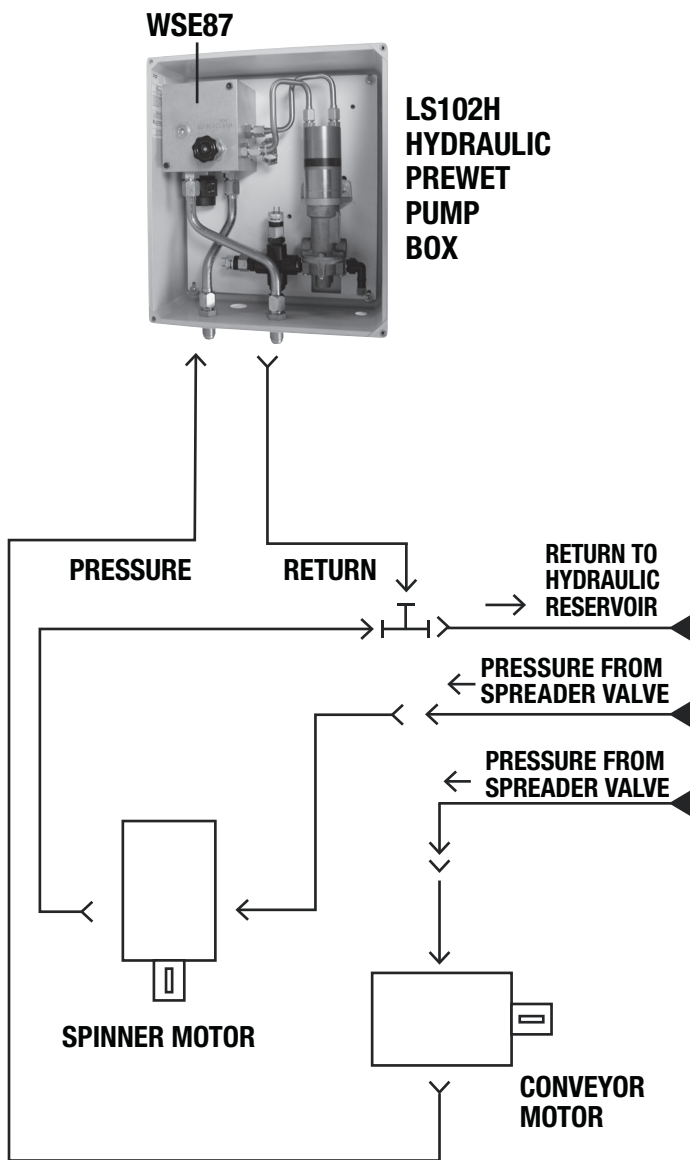

Fig. 3 - Prewet Plumbing Diagram

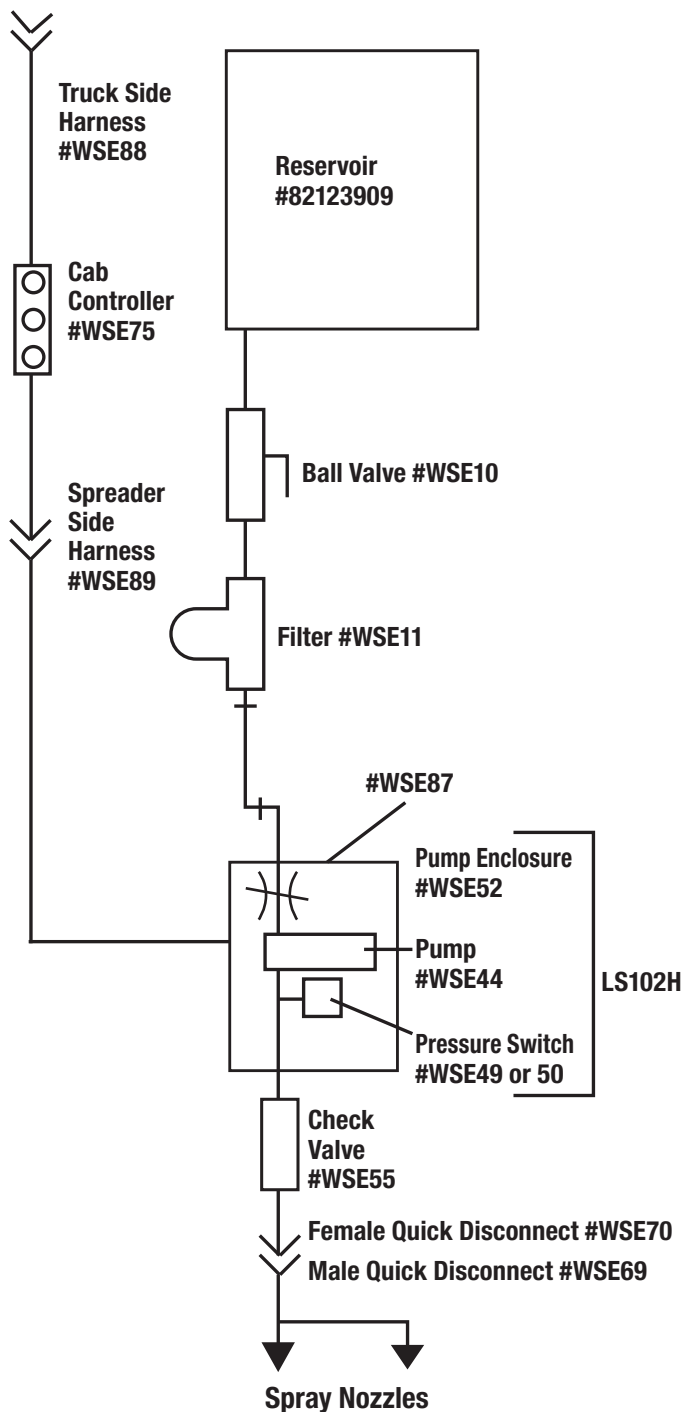

Fig. 4 - Filter/Valve Assembly

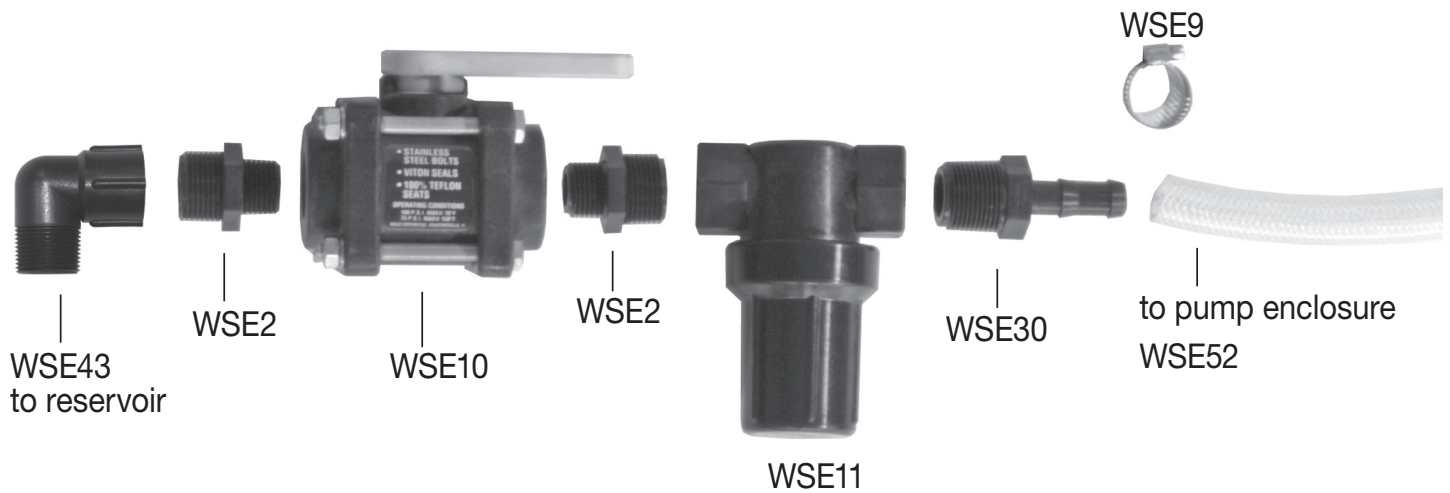
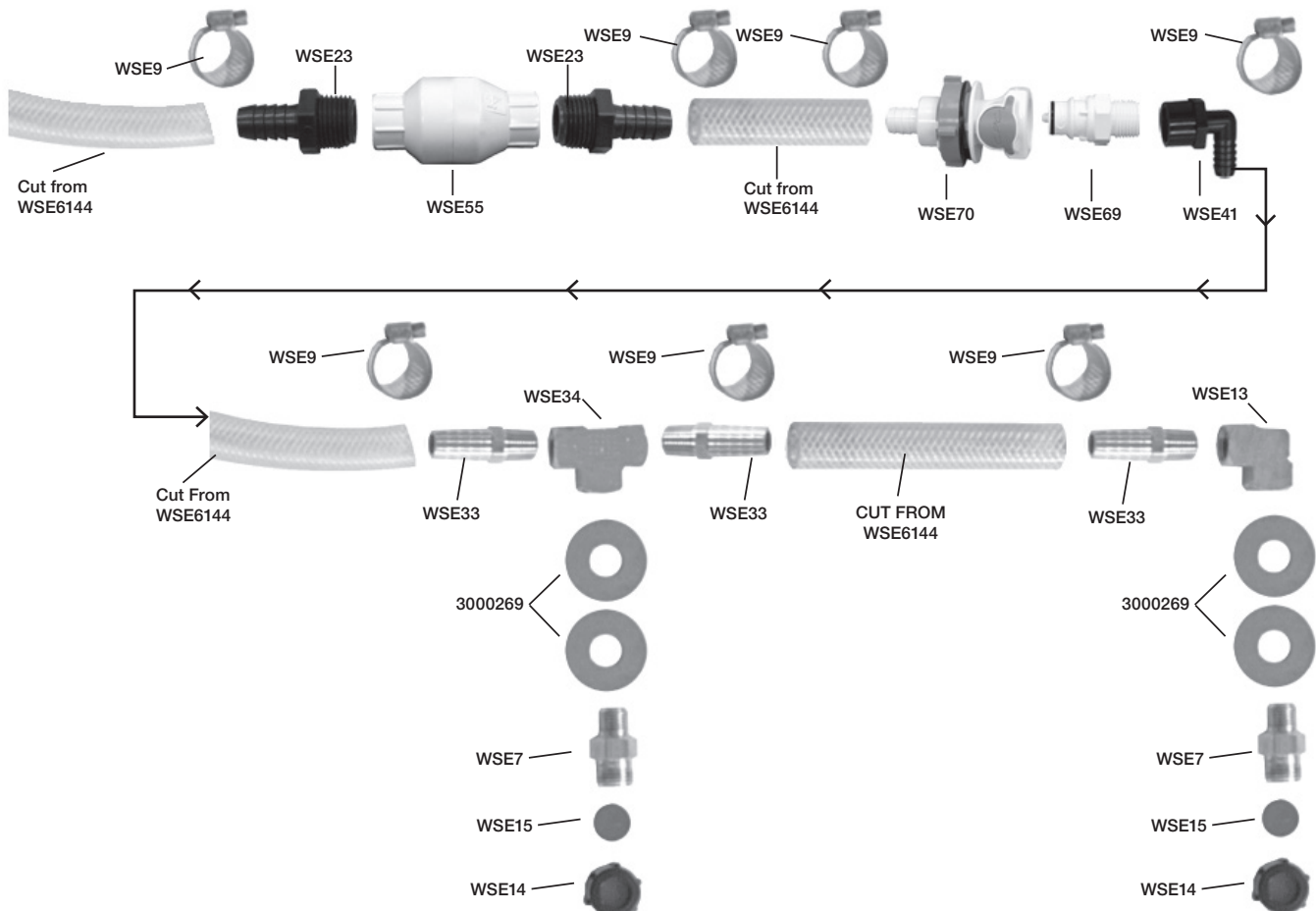

Fig. 5 - Nozzle Assembly



Bill of Materials

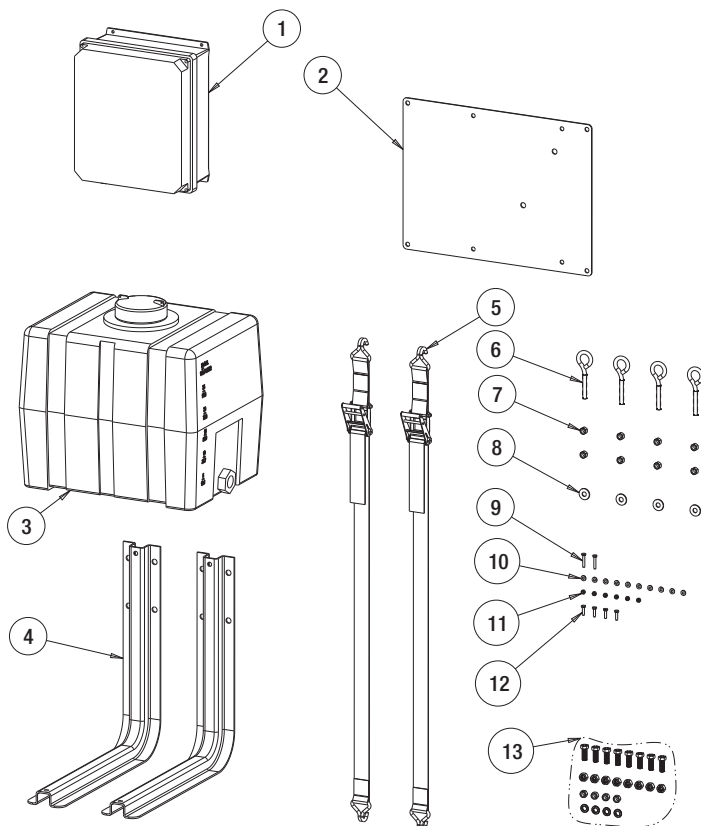
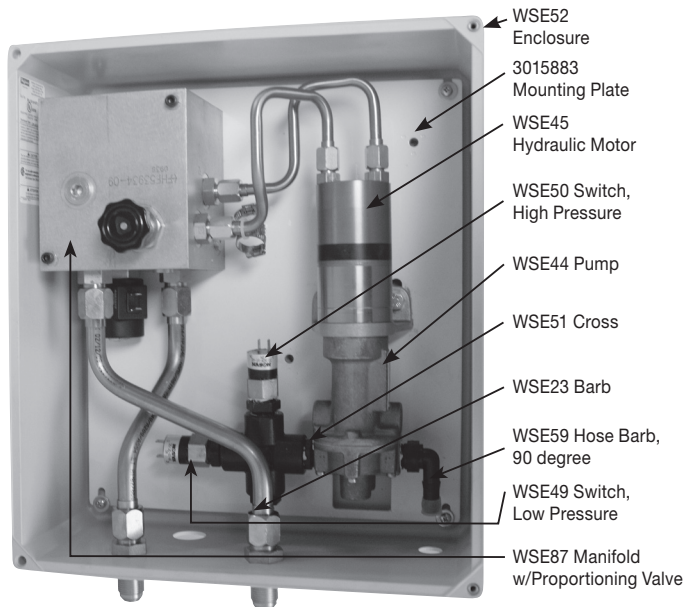

Fig. 6 WSE100 Hydraulic Prewet Pumpbox Reference



WARRANTY

Buyers Products Co. warrants all truck/trailer hardware manufactured or distributed by it, to be free from defects in material and workmanship for a period of one year from date of shipment. Parts must be properly installed and used under normal conditions. Any product which has been altered, including modification, misuse, accident or lack of maintenance will not be considered under warranty. Normal wear is excluded. The sole responsibility of Buyers Products Co. under this warranty is limited to repairing or replacing any part or parts which are returned, prepaid, and are found to be defective by Buyers Products Co. Authorization from Buyers Products Co. must be obtained before returning any part. No charges for transportation or labor performed on Buyers' products will be allowed under this warranty.

ITEM	PART NO.	QTY.	DESCRIPTION
1	WSE100	1	ENCLOSURE ASSY, HYD
<i>SEE FIGURE 6 FOR INTERNAL COMPONENTS OF WSE100</i>			
2	3017949	1	BRACKET, MOUNT, WSE100
3	82123909	1	RESERVOIR, 30 GALLON
4	3005186	2	BRACKET, RESERVOIR SUPPORT
5	149650501	2	STRAP ASSY, RATCHET
6	3015006	4	EYEBOLT, 1/2-13 X 3IN LONG
7	FNE050013041G5	8	NUT, ELASTIC STOP, 1/2-13
8	FWF050138014	4	WASHER, FLAT, 1/2
9	FCS025020150SS	2	SCREW, HEX HEAD, 1/4-20 X 1-1/2
10	FWF025063007SS	10	WASHER, FLAT, 1/4
11	FNE025020031SS	6	NUT, ELASTIC STOP, 1/4-20
12	FCS025020100SS	2	SCREW, HEX HEAD, 1/4-20 X 1
13	SMD005DKHDW	1	HARDWARE BAG, TANK MOUNT
<i>FOLLOWING PARTS ARE SHOWN ON FIGURES 4 AND 5</i>			
	3000269	4	WASHER, FLAT, 1/2 USS SST
	WSE2	2	NIPPLE, POLY, HEX 3/4 X 1/2
	WSE7	2	NOZZLE BODY, BRASS
	WSE9	10	HOSE CLAMP
	WSE10	1	BALL VALVE, POLY, 1/2 FNPT
	WSE11	1	FILTER, POLY, 3/4 FNPT
	WSE13	1	ELBOW, BRASS, 1/4 FNPT X 1/4 FNPT
	WSE14	2	NOZZLE, CAP
	WSE15	2	NOZZLE, RUBBER
	WSE23	2	BARB, POLY, 1/2 MNPT X 1/2 HB
	WSE30	1	BARB, POLY, 3/4 MNPT X 1/2 HB
	WSE33	3	BARB, HOSE, BRASS, 1/4 MNPT X 1/2 HB
	WSE34	1	TEE, BRASS, 1/4 FNPT X 1/4 FNPT X 1/4 FNPT
	WSE41	1	ELBOW, POLY, 1/2 FNPT X 1/2 HB
	WSE43	1	STREET ELBOW, POLY, 3/4 NPT
	WSE55	1	CHECK VALVE
	WSE69	1	QUICK COUPLER, POLY, 1/2 MNPT X 3/4 MALE
	WSE70	1	QUICK COUPLER, POLY, 1/2 BARB X 3/4 FEMALE
	WSE6144	1	HOLE, POLY, 1/2 X 144 IN
<i>FOLLOWING PARTS ARE SHOWN IN FIGURES 1 AND 3</i>			
	WSE75	1	CONTROLLER, IN CAB
	WSE88	1	HARNESS, TRUCK SIDE
	WSE89	1	HARNESS, SPREADER SIDE

CAUTION

Always wear hand, eye, and skin protection when working with de-icing chemicals. Make sure everyone is standing clear of liquid spray system before operating.

SAFETY ALERT SYMBOL



This Symbol Means **ATTENTION!**
Please Read & Understand Completely
Before Operating!

EQUIPMENT INSTALLERS & OPERATORS:

TURN OFF ALL POWER BEFORE PERFORMING ANY SERVICE OPERATIONS.

- Follow Recommended Operating Procedure.
- Keep Equipment In Safe Operating Condition At All Times.
- Recognize & Avoid Hazards While Operating, Servicing and Maintaining Equipment.

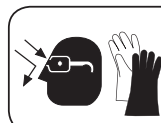

CAUTION
**RESERVOIR & COMPONENTS MAY
CONTAIN HAZARDOUS MATERIAL.
HANDLE WITH CARE.**